

MECHANICAL SEALS

**TC/FH
TC/FHC
TC/FH6**

LIDERING

OPERATING LIMITS

$d_1 = 10 \div 100 \text{ mm}$

$p = 10 \text{ Kg/cm}^2$

$v = 20 \text{ m/s}$

$t = -70 \div +200^\circ\text{C}$

The operating limits depend on the PV factor

COMPONENTS

1 Rotative face

2 Stationary face

3 O-ring

3a O-ring

3b O-ring

4 Spring

5 Metal frame

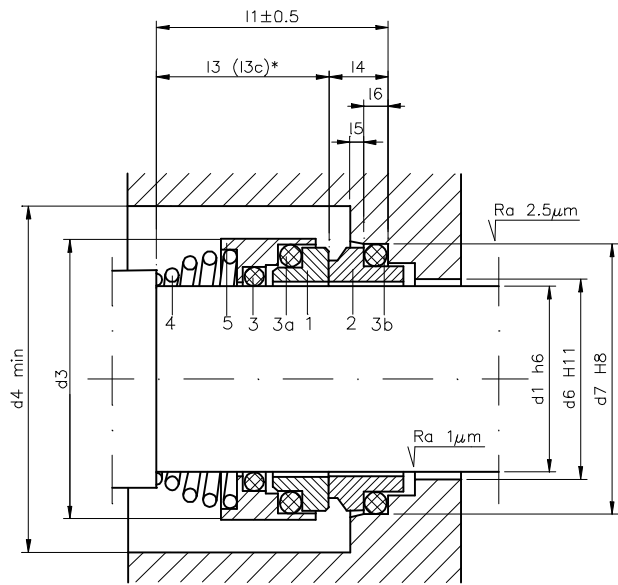

REFERENCE

MATERIALS

TC/FH -- VBPGG	Aluminium oxide	Graphite	NBR	SS AISI 316
TC/FH -- VB ₂ PGG	Aluminium oxide	Graphite	NBR	SS AISI 316
TC/FH -- VBMGG	Aluminium oxide	Graphite	FEP	SS AISI 316
TC/FH -- VYPGG	Aluminium oxide	PTFE	NBR	SS AISI 316
TC/FH -- UUPGG	Tungsten carbide	Tungsten carbide	NBR	SS AISI 316
TC/FH -- U ₁ U ₁ PGG	Antiacide tungsten carb.	Antiacide tungsten carb.	NBR	SS AISI 316
TC/FH6 -- VBTGG	Aluminium oxide	Graphite	PTFE	SS AISI 316
TC/FH6 -- VYTGG	Aluminium oxide	PTFE	PTFE	SS AISI 316

Available in other materials

TC - FH / TC - FHC / TC - FH6

Unbalanced mechanical seal, single seal, dependent on direction of rotation.

DIMENSIONS TABLE (Measures in mm. subject to change)

Ref.	d ₁	d ₃	d ₄	d ₆	d ₇	l ₁	l ₃	l ₄	l ₅	l ₆	l _{3c}
010	10	20	22	14	18.1	25.5	20	5.5	1.2	3	15
012	12	22	25	16.5	20.6	27.5	22	5.5	1.2	3	18
014	14	25	28	19	23.1	33	27	6	1.2	3	22
015	15	29	32	21	26.9	34	27	7	1.5	4	22
016	16	29	32	21	26.9	35	28	7	1.5	4	23
018	18	33	36	25	30.9	38	30	8	1.5	4	24
020	20	33	36	25	30.9	38	30	8	1.5	4	25
022	22	38	41	30	35.4	38	30	8	2	4	25
024	24	38	41	30	35.4	40	32	8	2	4	27
025	25	40	45	33	38.2	41.5	33	8.5	2	4	27
026	26	40	45	33	38.2	41.5	33	8.5	2	4	27
028	28	46	50	38	43.3	45	36	9	2	4	29
030	30	46	50	38	43.3	46	37	9	2	4	30
032	32	46	50	38	43.3	46	37	9	2	4	30
034	34	56	62	45	53.5	59.5	48	11.5	2	6	39
035	35	56	62	45	53.5	59.5	48	11.5	2	6	39
036	36	56	62	45	53.5	59.5	48	11.5	2	6	39
038	38	63	70	52	60.5	59.5	48	11.5	2	6	39
040	40	63	70	52	60.5	59.5	48	11.5	2	6	39
042	42	63	70	52	60.5	59.5	48	11.5	2	6	39
043	43	63	70	52	60.5	59.5	48	11.5	2	6	41
045	45	69	75	57	65.5	62.5	51	11.5	2	6	41
048	48	69	75	57	65.5	62.5	51	11.5	2	6	41
050	50	76	83	64	72.5	66.5	55	11.5	2	6	45
055	55	76	83	64	72.5	68.5	57	11.5	2	6	47
060	60	84	90	72	79.3	72.5	61	11.5	2	6	49
065	65	89	96	77	84.5	74.5	63	11.5	2	6	51
070	70	94	101	82	89.5	74.5	63	11.5	2	6	51
075	75	100	106	87	94.5	79.5	68	11.5	2	6	57
080	80	105	111	92	99.5	81.5	70	11.5	2	6	59
085	85	115	125	98	105.5	85.5	72	13.5	2.5	6	59
090	90	120	132	105	111.5	88.5	75	13.5	2.5	6	62
095	95	126	137	110	116.5	88.5	75	13.5	2.5	6	62
100	100	130	143	114	119.5	98.5	85	13.5	2.5	6	75

l_{3c} = measure reduced (TC-FHC)



LIDERING



LIDERING, S.A.

Pg. Ferrocarrils Catalans, 106 - 108
08940 Cornellà de Llobregat BARCELONA
Domestic Sales: 902 480 440
International Sales: +34 93 480 44 22
Fax: 93 480 44 04

Cyesa, 11 - 28017 MADRID
Tel: 902 480 440 Fax: 91 361 40 20

LIDERING, S.A.R.L.

Parc des Aqueducs, Lot E
Chemin du Favier RD 42
69230 Saint-Genis-Laval FRANCE
Tél: 04 72 67 02 67 Fax: 04 78 56 04 08

S.A. CONTINENTAL SEALS NEW N.V.
(LIDERING GROUP)

Ch. de Louvain 270 - Leuvensestwg
1410 Waterloo BELGIQUE-BELGIË
Tél: 02 357 06 30 Fax: 02 354 29 86

<http://www.lidering.com>