

MECHANICAL SEALS

TC/PNL

LIDERING

OPERATING LIMITS

d_1	= 8 ÷ 40 mm
p	= 12 Kg/cm ²
v	= 10 m/s
t	= -20 ÷ +120°C
The operating limits depend on the PV factor	

COMPONENTS

1	Rotative face
2	Stationary face
3	Bellows
3a	Rubber joint
4	Spring
5	Ring
5a	Ring retainer
5b	Metal frame

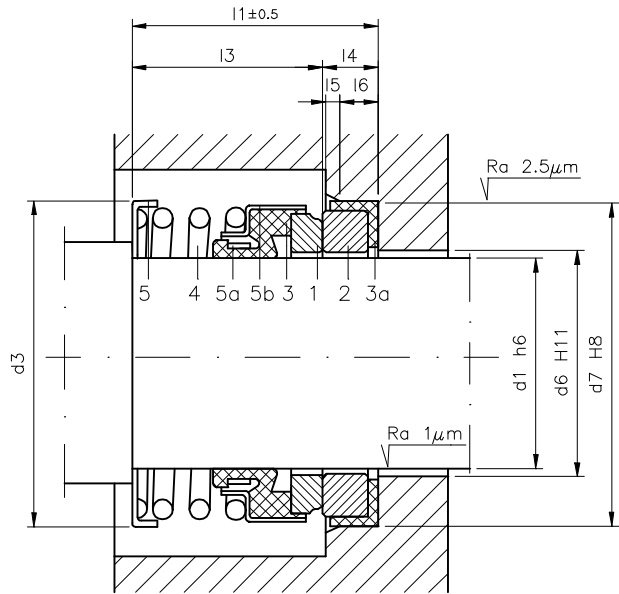

REFERENCE

MATERIALS

TC/PNL -- BXPFF	Graphite	Ceramic	NBR	SS AISI 304
TC/PNL -- BVPFF	Graphite	Aluminium oxide	NBR	SS AISI 304

Available in other materials

TC - PNL

Bellows mechanical seal, unbalanced, single spring, indepent on direction of rotation.

DIMENSIONS TABLE (Measures in mm. subject to change)

Ref.	d ₁	d ₃	d ₆	d ₇	l ₁	l ₃	l ₄	l ₅	l ₆
008	8	22	14	26	21	15.5	5.5	0.5	4.5
010	10	22	14	26	21	15.5	5.5	0.5	4.5
011	11	22	14	26	21	15.5	5.5	0.5	4.5
012	12	22	14	26	21	15.5	5.5	0.5	4.5
013	13	28	17	29.5	26	18	8	1	6
013	13	32	17	29.5	21	13	8	1	6
014	14	28	17	29.5	26	18	8	1	6
014	14	28	19	23.1	28	22	6	1.2	3
014	14	32	17	29.5	21	13	8	1	6
015	15	28	17	29.5	26	18	8	1	6
015	15	32	17	29.5	21	13	8	1	6
016	16	28	17	29.5	26	18	8	1	6
016	16	28	21	26.9	30	23	7	1.5	4
016	16	31	17	29.5	37	29	8	1	6
016	16	32	17	29.5	21	13	8	1	6
016	16	32	17	42	21	13	8	1	6
016	16	33	17	29.5	24	16.3	8	1	6
018	18	32	20	42	32	24	8	1	6
018	18	32	25	30.9	32	24	8	1.5	4
019.05	19.05	32	22	35	24	13.8	10.2	1.2	7.8
019.05	19.05	32	22	35	32.2	22	10.2	1.2	7.8
020	20	32	22	42	30	22	8	1	6
020	20	44	22	42	22	14	8	1	6
022	22	39	30	35.4	33	25	8	2	4
022	22	44	23	42	22	14	8	1	6
025.4	25.4	42	29	41.25	38.2	27.2	11	1.5	8.5
030	30	52	33	52	40	28	12	1.5	8.5
030	30	60	33	52	34	22	12	1.5	8.5
031.75	31.75	52	34	47.62	60.2	49.2	11	1.5	8.5
040	40	63	45	68	47	35	12	1.5	8.5



LIDERING



LIDERING, S.A.

Pg. Ferrocarrils Catalans, 106 - 108
08940 Cornellà de Llobregat BARCELONA
Domestic Sales: 902 480 440
International Sales: +34 93 480 44 22
Fax: 93 480 44 04

Cyesa, 11 - 28017 MADRID
Tel: 902 480 440 Fax: 91 361 40 20

LIDERING, S.A.R.L.

Parc des Aqueducs, Lot E
Chemin du Favier RD 42
69230 Saint-Genis-Laval FRANCE
Tél: 04 72 67 02 67 Fax: 04 78 56 04 08

S.A. CONTINENTAL SEALS NEW N.V.
(LIDERING GROUP)

Ch. de Louvain 270 - Leuvensestwg
1410 Waterloo BELGIQUE-BELGIË
Tél: 02 357 06 30 Fax: 02 354 29 86

<http://www.lidering.com>